

# Invisible Soft Closing Framed Door Installation Manual

## i Product assembly diagram

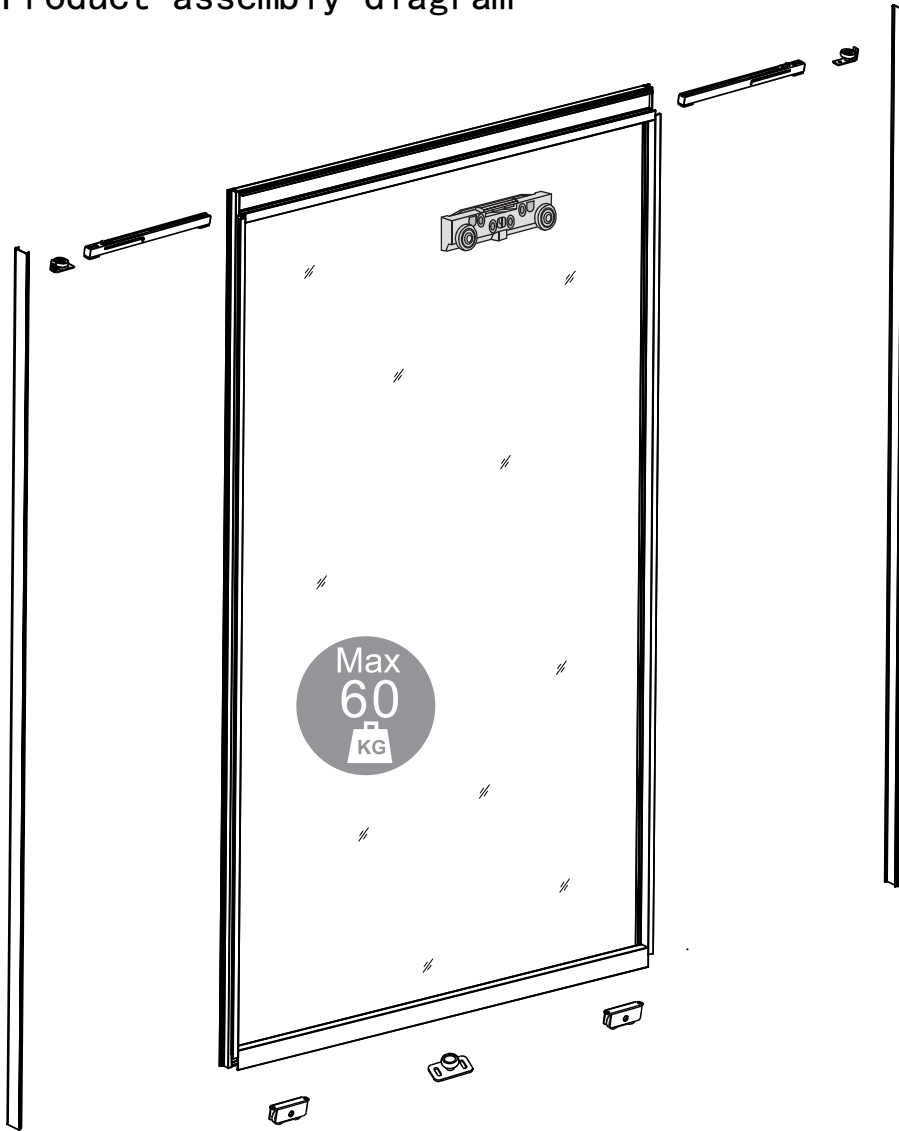

- $\Phi 4 \times 16$  X10
- ST4.2X13 X4
- $\Phi 8 \times 38$  X3
- $\Phi 6 \times 30$  X2
- $\Phi 5 \times 38$  X3
- M4X30 X2

## i Product Accessories

<b>A</b>  Cover X1	<b>B</b>  Bottom track X1	<b>C</b>  Upper track X1	<b>D</b>  Left Framed profile X1 Right Framed profile X1
<b>E</b>  Hanging Roller X1	<b>F</b>  Fixed wheel X2	<b>G</b>  Damper X2	<b>H</b>  Bottom wheel X2
<b>I</b>  Bottom Guide X1	<b>J</b>  $\Phi 4 \times 16$ X10	<b>K</b>  ST4.2X13 X4	<b>L</b>  $\Phi 8 \times 38$ X3
<b>M</b>  $\Phi 6 \times 30$ X2	<b>N</b>  $\Phi 5 \times 38$ X3	<b>O</b>  M4X30 X2	<b>P</b>  Left Framed End Cap X1 Right Framed End Cap X1

## Tools

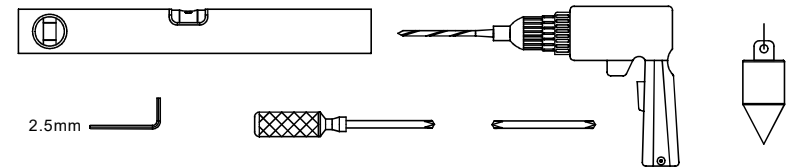

Left Open Diagram

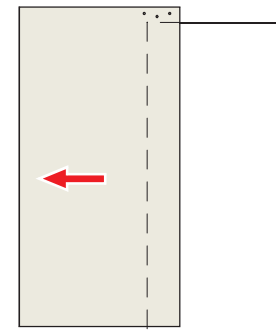

Right Open Diagram

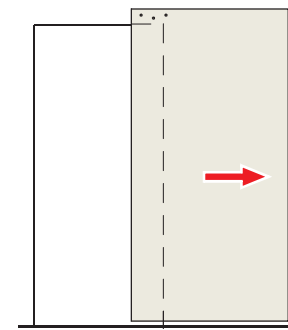

# Invisible Soft Closing Framed Door Installation Manual

## i Installation Calculation diagram

Installation mode 1 : Center

Door width: Door's hole +111+111 (mm) Door height: Door's hole +47 (mm) Gap between door and wall: 7mm

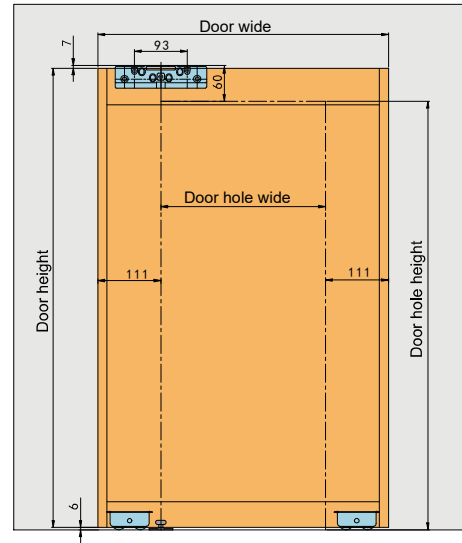
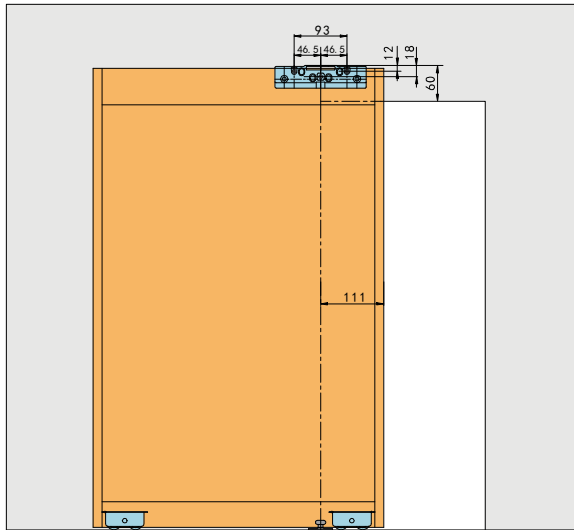

The Position of Floor Guide

Close door

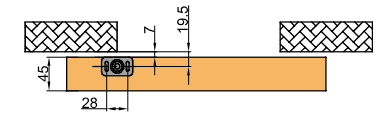

Open door

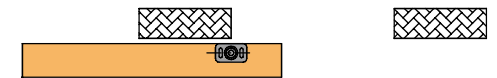

Installation mode 2 : Parallel and level

Door width: Door's hole +111+111 (mm) Door height: Door's hole +47 (mm) Gap between door and wall: 7mm

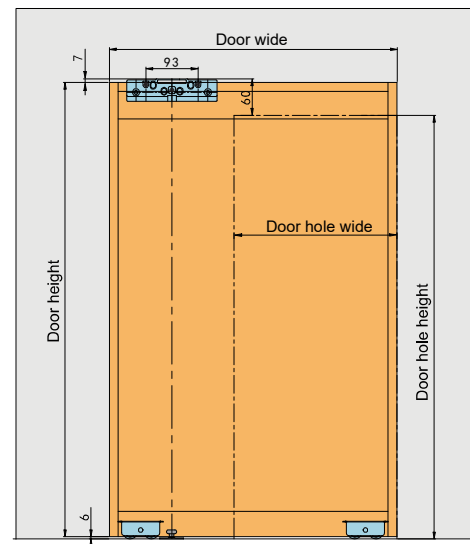
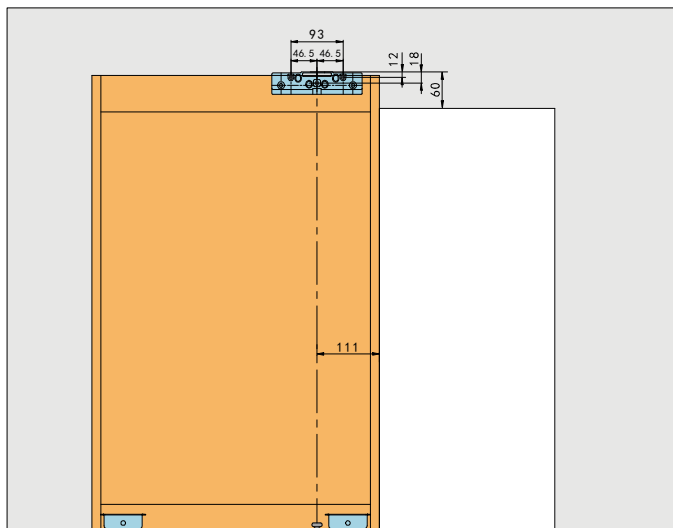

The Position of Floor Guide

Close door

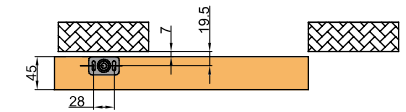

Open door

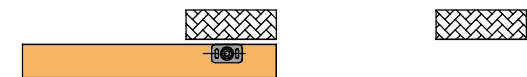

# Invisible Soft Closing Framed Door Installation Manual

## i Door dimensions calculation

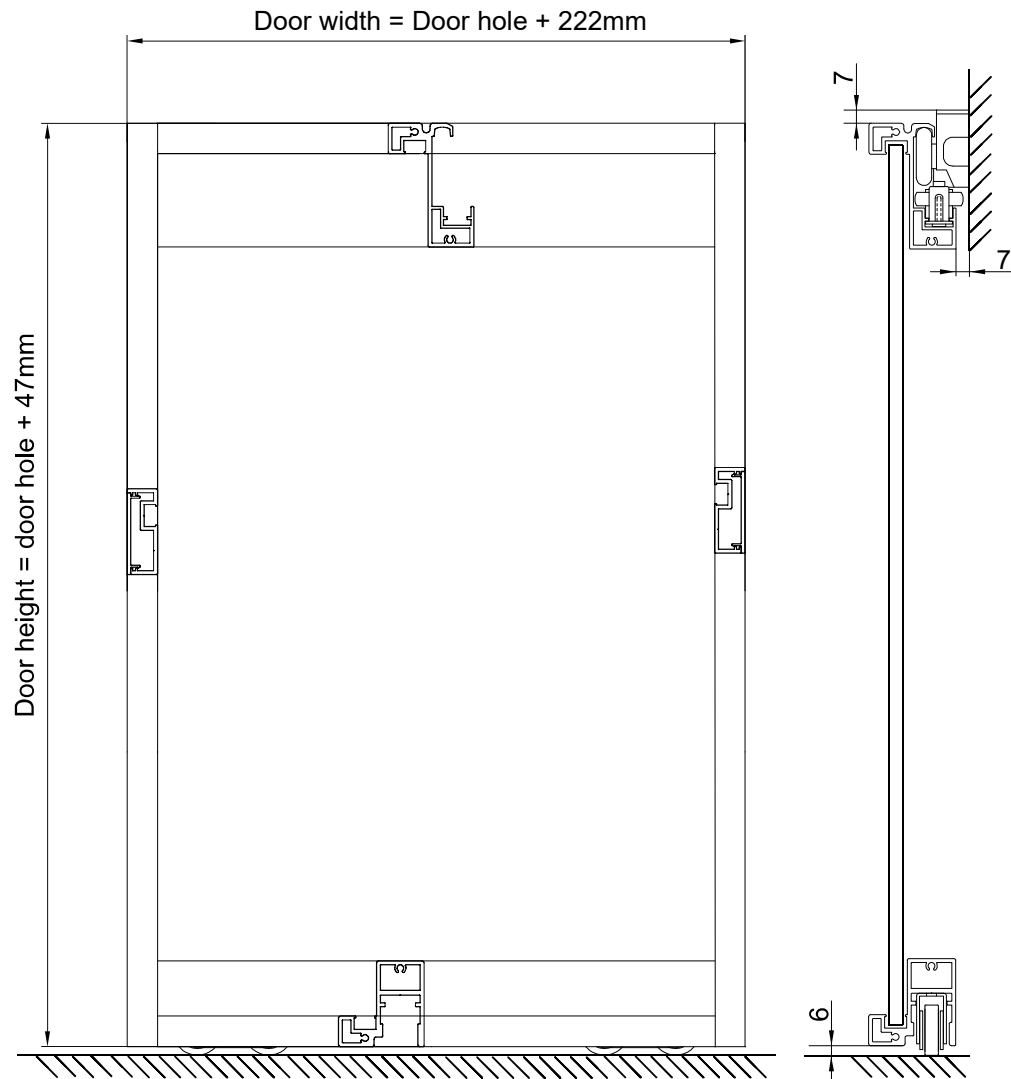

Door width=860mm-1232mm

Door height ≤ 2600mm

## i Profile and glass dimension calculation

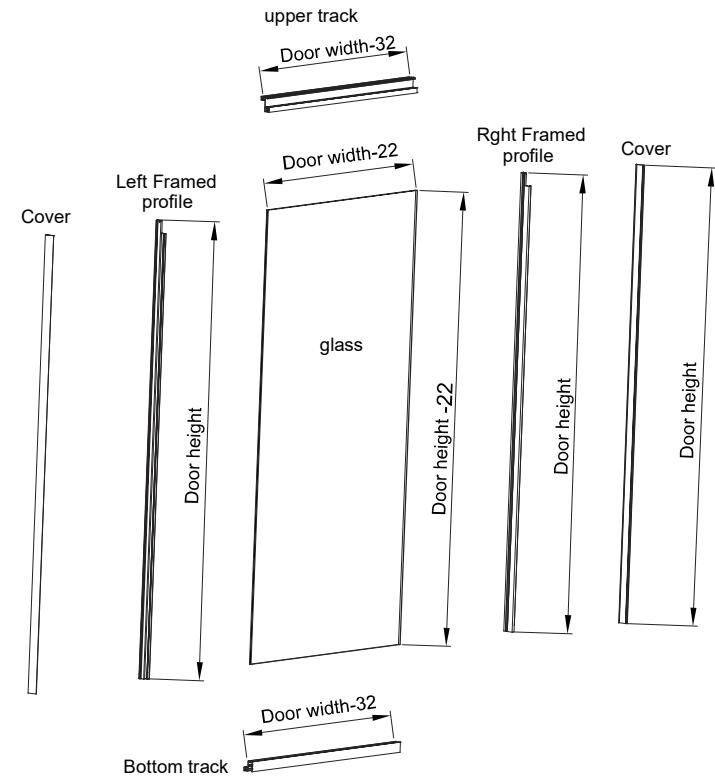

## i Framed door profile dimensions

Cut the length based on door dimensions

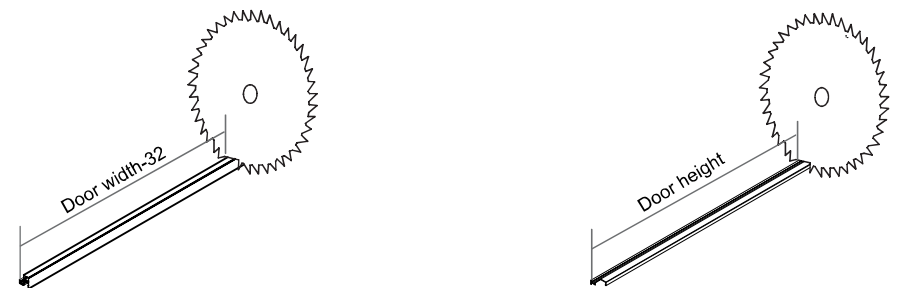

Bottom track, Upper track

Cover, Left Framed profile, Right Framed profile

# Invisible Soft Closing Framed Door Installation Manual

1. Drill the 4mm hole on left & right fraemd profile.

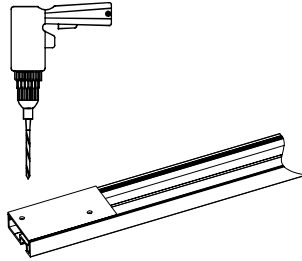

2. Fix the bottom wheel on the bottom track with ST4. 2X13 screws.

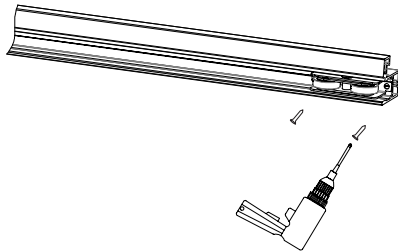

3. Install the damper on upper track (52mm distance), fasten the screws.

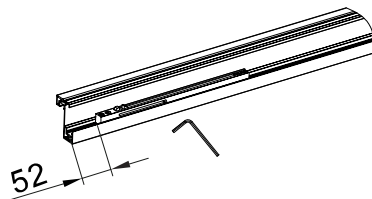

4. Install the guide wheel into track, make sure it is in parallel and level by using 2.5mm spanner.

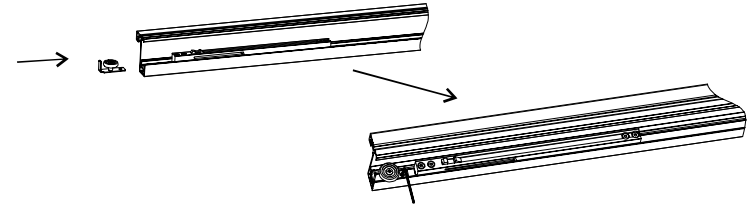

5. Assemble the framed profile in parallel and level by using 4X16 screws.

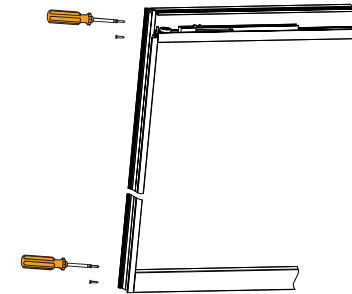

6. Assemble the glass and profile by using neutral glass cement, after it is in drying conition, then assemble the cover on framed door .

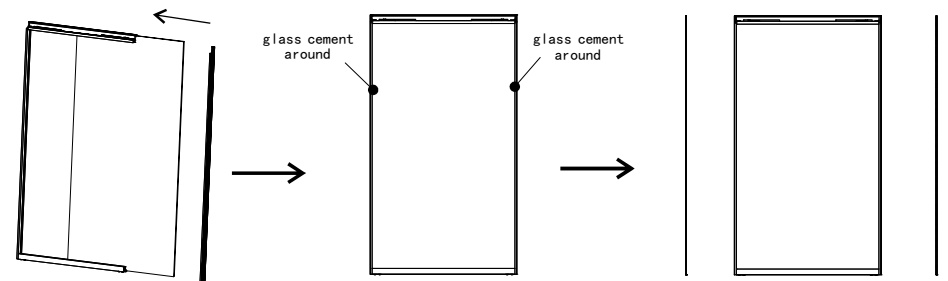

# Invisible Soft Closing Framed Door Installation Manual

## **i** Framed door installation and adjustment

Install the upper wheel

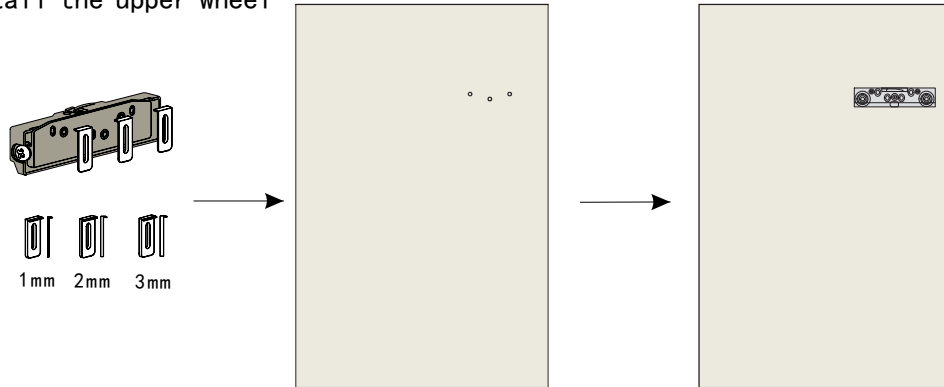

1. According to the door installation calculation diagram, fix the wheel on the wall.

Adjust the door height

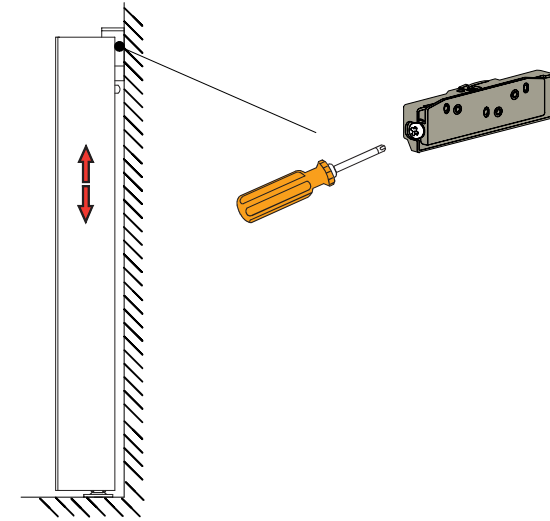

3. Rotate the side screws to adjust 3mm height.

Hang the door up

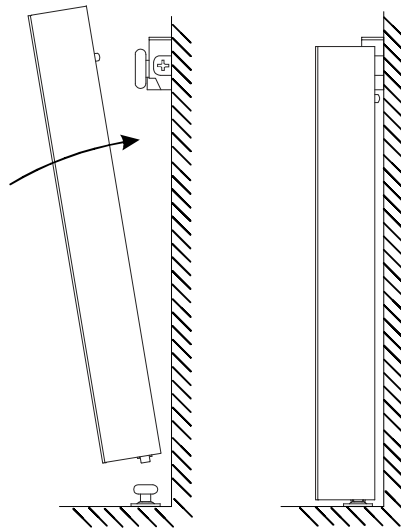

2. Make sure the damper is in right position, the track on the wheel and bottom guide is into bottom track.

Turn on the anti-tripping function

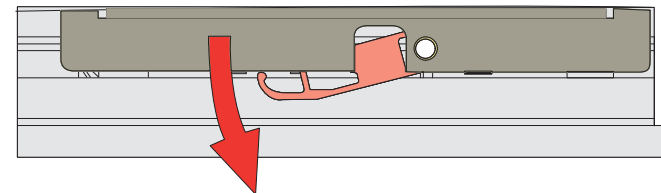

4. Make sure the safe hook is open Installation Finished.